

## FLAT SCREEN WALL MOUNT FOR SCREENS UP TO 80"

**B-Tech Elements** products offer the core traits that B-Tech is known for, exceptional build quality, strength, and reliability, without some of the premium features typically reserved for our flagship mounts. Designed for large-sized screens, the **BT5442** is a slim profile flat screen wall mount capable of mounting displays of up to 70kg at a depth of just 27mm from the wall. Perfect for hospitality and similar applications, the mount includes a universal interface compatible with VESA patterns up to 650 x 400mm. For added convenience, built-in lateral adjustment and a quick-release locking mechanism are featured, ensuring a flexible, hassle-free installation.

### SPECIFICATIONS

Recommended screen size	up to <b>80"</b>
Max load	<b>70kg</b>
VESA <sup>®</sup> & non-VESA fixings	up to <b>650 x 400mm</b>
Distance from wall	<b>27mm</b>

### FEATURES

- 1 Low profile design mounts screen only 27mm from the wall
  - 2 Lateral adjustment of the screen once mounted
  - 3 Easy to use locking mechanism with pull-to-release cord
  - 4 Simple 'hook-on' installation with all mounting hardware included
- Contemporary design featuring aesthetic end caps



RECOMMENDED MAX SCREEN	MAX LOAD	MAX VESA	POST INSTALL ALIGNMENT	
80" 203cm	70kg	600 x 400	← →	

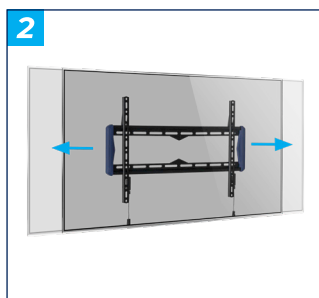

# BT5442

## elements • fixed 600

**BTech**<sup>®</sup>  
AV Mounts

elements

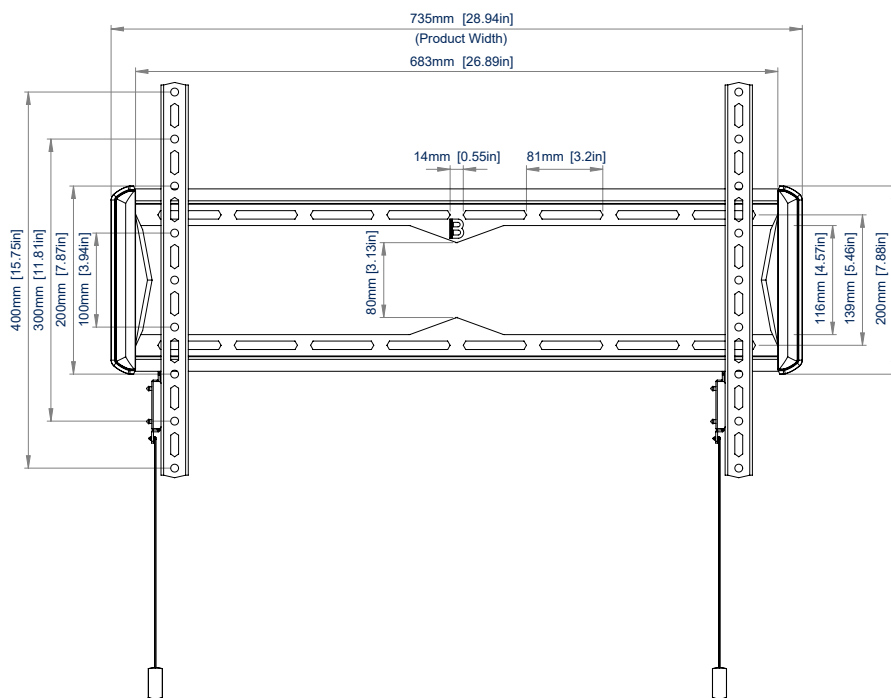

FRONT VIEW

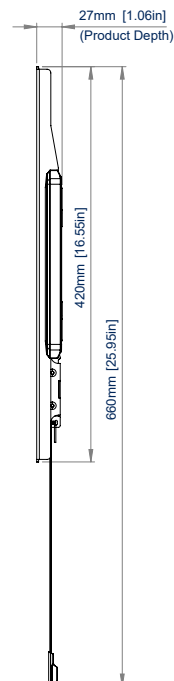

SIDE VIEW



BOTTOM VIEW

### ORDERING INFORMATION

COLOUR	ORDER REF	EAN
Black	BT5442/B	5019318308772

### RELATED PRODUCTS

PRODUCT CODE	NAME	DESCRIPTION
BT5441	Fixed Flat Screen Wall Mount	Designed to mount screens up to 65"
BT8432	Flat Screen Wall Mount with Tilt	Designed to mount screens up to 80"
BT8228	Flat Screen Wall Mount with Tilt & Swivel	Double Arm solution designed to mount screens up to 120"
BT9903	XL Fixed Flat Screen Wall Mount	Designed to mount screens up to 120"

© 2024 B-Tech AV Mounts. All rights reserved.  
The information in this specification sheet reflects the current technical specifications at the time of printing.  
We reserve the right to change the technical or physical specifications without prior notice. The B-Tech name and the B-Tech logo are registered trademarks of B-Tech AV Mounts Corporation Ltd.  
B-Tech accepts no liability for loss or damage caused by improper installation or mounting on unstable structures. Any reproduction or use of this specification sheet is strictly prohibited unless prior written permission is obtained from B-Tech AV Mounts Corporation Ltd. (B-Tech).

SS-V1-BT5442-110924



B-Tech AV Mounts

[www.btechavmounts.com/bt5442](http://www.btechavmounts.com/bt5442)