

# Omnichart 36

## Charging cart

Notebook | Chromebook | Tablet (max 15.6")  
VR Visors | Headsets | Rechargeable devices

Charging cart for up to 36 devices (max. 15.6") - 24 VR Visors

**HLGOMN36BLWH**

OmniChart **36**

85 x 65 x 123 cm

**3**  
year  
warranty



### **Product compatible**

with all rechargeable devices

Up to 24 VR Visors - Headsets - Accessories

# Structure

- All-metal construction with natural air circulation, 4 swivelling wheels with brakes and two plastic side handles to move the chart comfortably where needed.
- Front compartment for housing devices equipped with security lock and double door retractable in the body of the unit.
- Top compartment with security lock e power-assisted opening/closing system with double gas pistons.
- Rear compartment for housing of power supplies, equipped with a double door with lock security lock.



# Power Supply and Charging



- Rear compartment not accessible from the front and top compartments, equipped with grommet holes to connect devices to the power supply.
- Equipped with four strips of 9 sockets each and compartment for positioning the converters.
- Control unit for timing the power supply simultaneously on all sockets or in timed sequence to avoid overloads.
- Single 5m power cable integrated in the power supply unit.

# Storage and Compatibility

Three fixed shelves with 12 dividing bulkheads removable plastic dividers with grommets integrated for housing devices in an upright position.

Removable dividers, as per instructions below.

Removing the dividers makes it possible to adapt the trolley to the charging of any type of device, including accessories such as VR viewers and headsets (as an example).



## Product compatible

with all rechargeable devices



In three simple steps, the dividers can be removed to adapt the Omnichart 36 charging cart to every need.

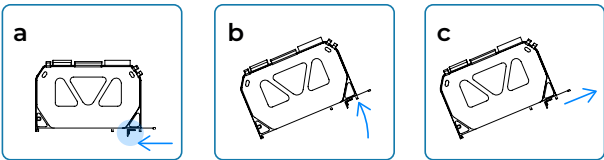

Product gallery



Product exterior details

Handle | Front lock | Upper compartment | Swivel castors



Product exterior details

Cable reels | Power outlets | Programming unit



Interior details

Modular and fully removable | Concealed doors

CE-certified trolley for the following standards	EN 55032:2015	EN 61000-3-2:2014
	EN 55035:2017	EN 61000-3-3:2013
2014/30/EU Electromagnetic Compatibility Directive		
CE-certified control unit	EN 62368-1:2014+A11:2017	



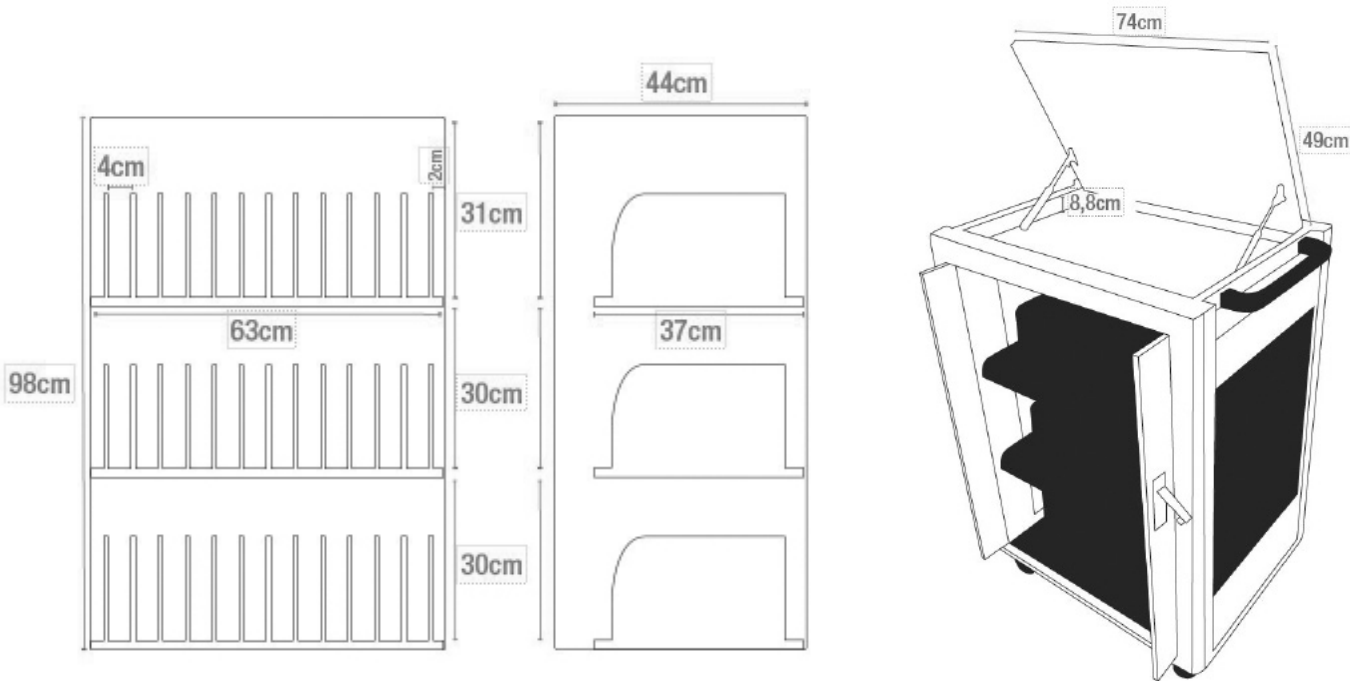



**[www.HELGI-europe.com](http://www.HELGI-europe.com)**

**HELGI Europe**

[education@helgi-europe.com](mailto:education@helgi-europe.com)

[business@helgi-europe.com](mailto:business@helgi-europe.com)

#09112023HLGOMNV36BLW\_EN

Dealer