

Quick Release Truss Clamp ID24

(25 to 38 mm truss capacity)

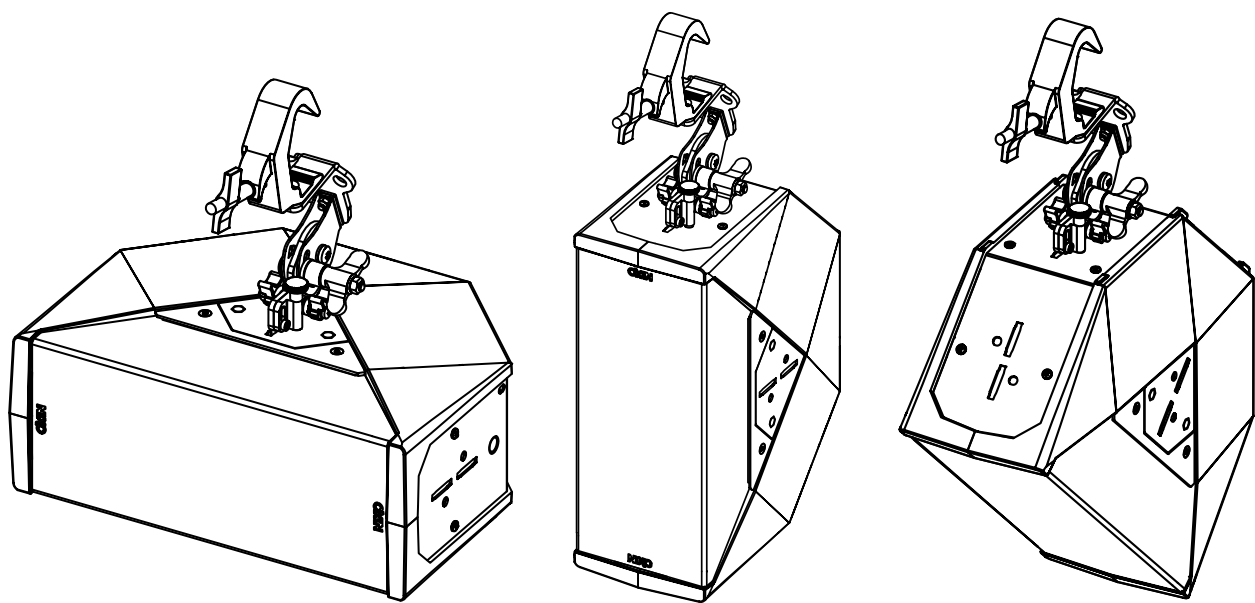

Contents:

X1 (QRA-V2)	X1	X1 M10x30	X1 M10	X1 M10	X1	X1

Weight: 0.75 kg / 1.65 lb



nexo-sa.com
ZA du Pre de la Dame Jeanne
60128 PLAAILLY - France

- Read this document before using.
- Keep this document.
- Observe all warnings and cautions.



Dimensions:

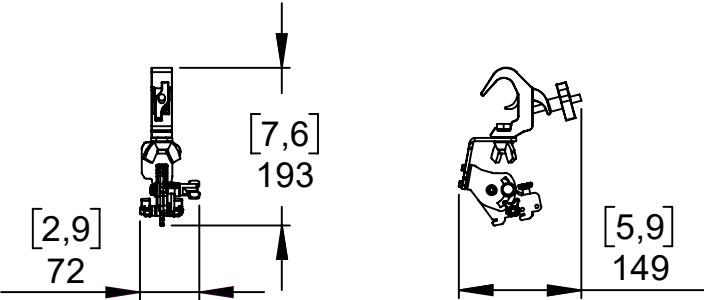

Assembly:

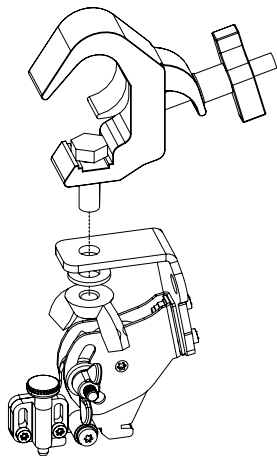

Implementation:

QRA can be moved in 2 different positions on the 5 locations.		You can find 5 locations, 2 to use horizontally and 3 vertically.	
Insert QRA and push until the locking device locks automatically.		Pull up the locking device, and push QRA to remove it.	

Use:

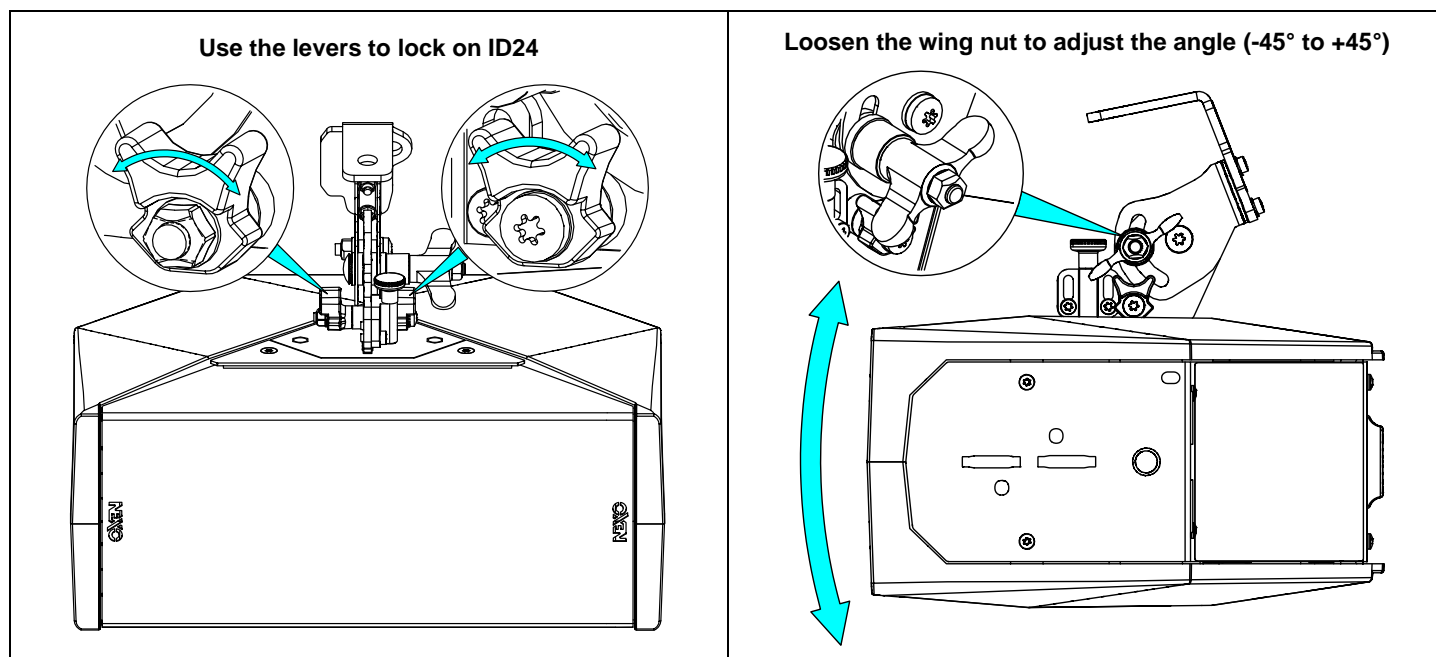

- Never exceed the Safe Working Load (SWL) shown on the clamp.
- Only use the clamp within the designed tube parameters (25-38mm).
- All clamps should be visually inspected before use. In the event of any damage, the clamp should be taken out of service and returned to an 'Approved NEXO Service Agent' for inspection.
- When used in conjunction with other accessories, care must be taken to ensure that the minimum SWL of any components is not exceeded.
- All open clamps including hook clamps should be used in a vertical orientation only.

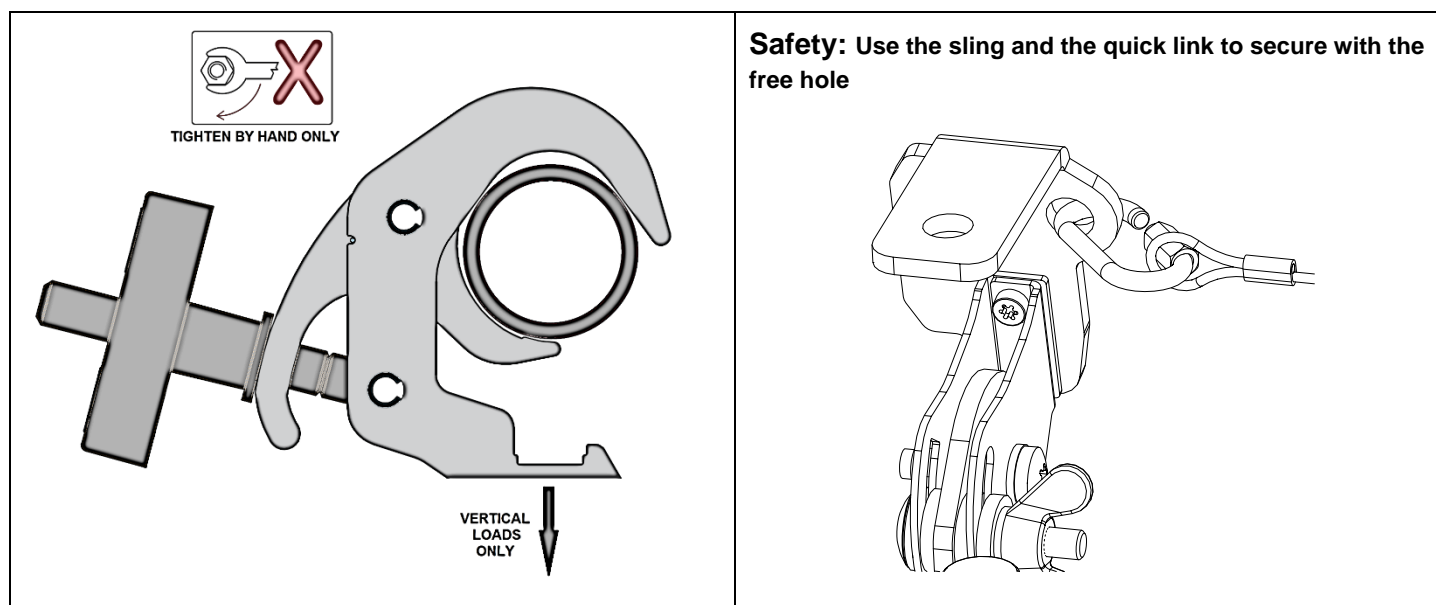

NEXO

nexo-sa.com

ZA du Pre de la Dame Jeanne
60128 PLAILLY - France

- Read this document before using.
- Keep this document.
- Observe all warnings and cautions.



Warning:

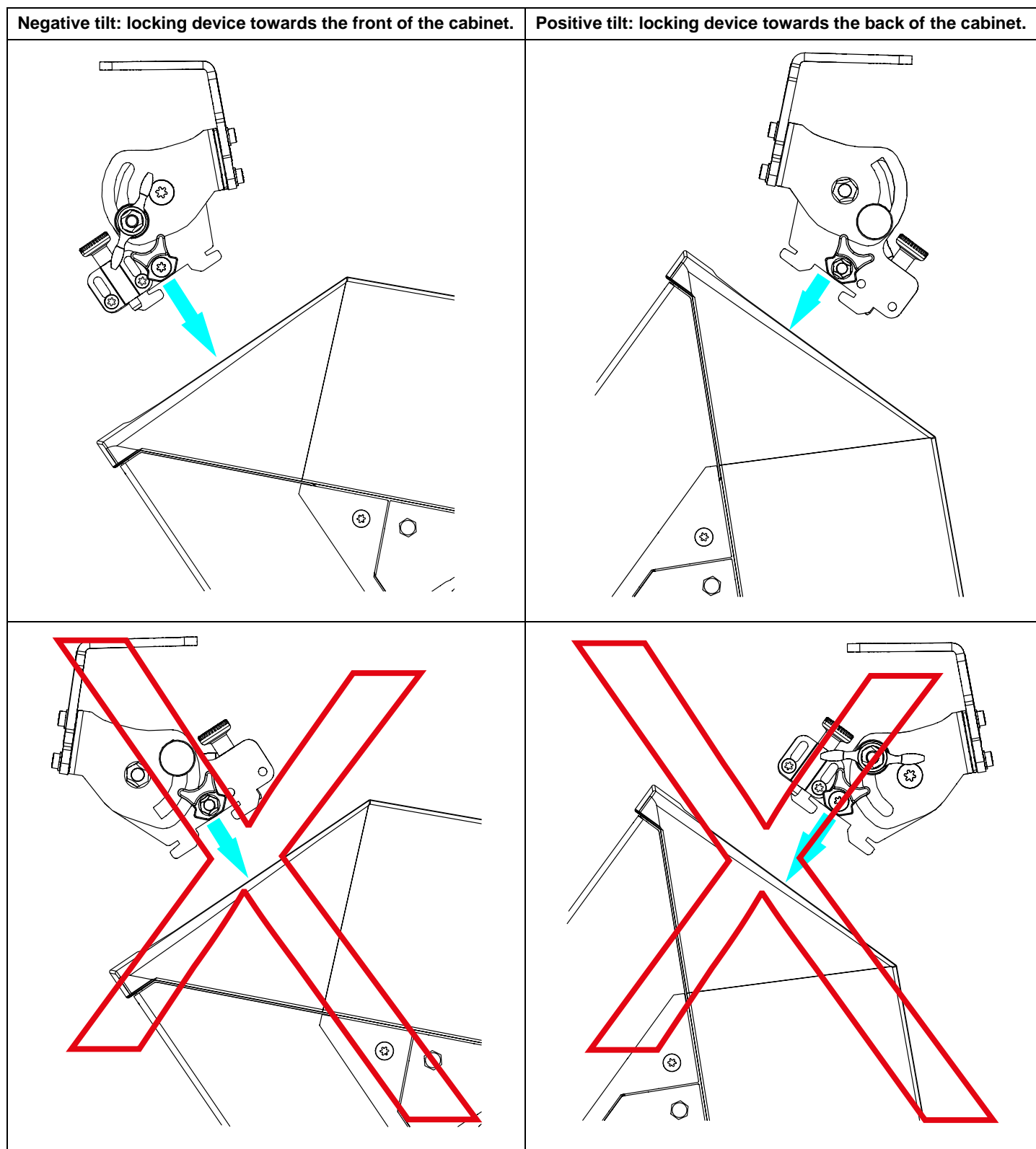

- **NEXO** cannot accept responsibility for accidents caused by any factor other than defects in this product itself.
- Please check the web site www.nexo-sa.com for the latest update.

NEXO

nexo-sa.com

ZA du Pre de la Dame Jeanne
60128 PLAILLY - France

- Read this document before using.
- Keep this document.
- Observe all warnings and cautions.

